

DO NOT SCALE

REV	DESCRIPTION	DATE	BY

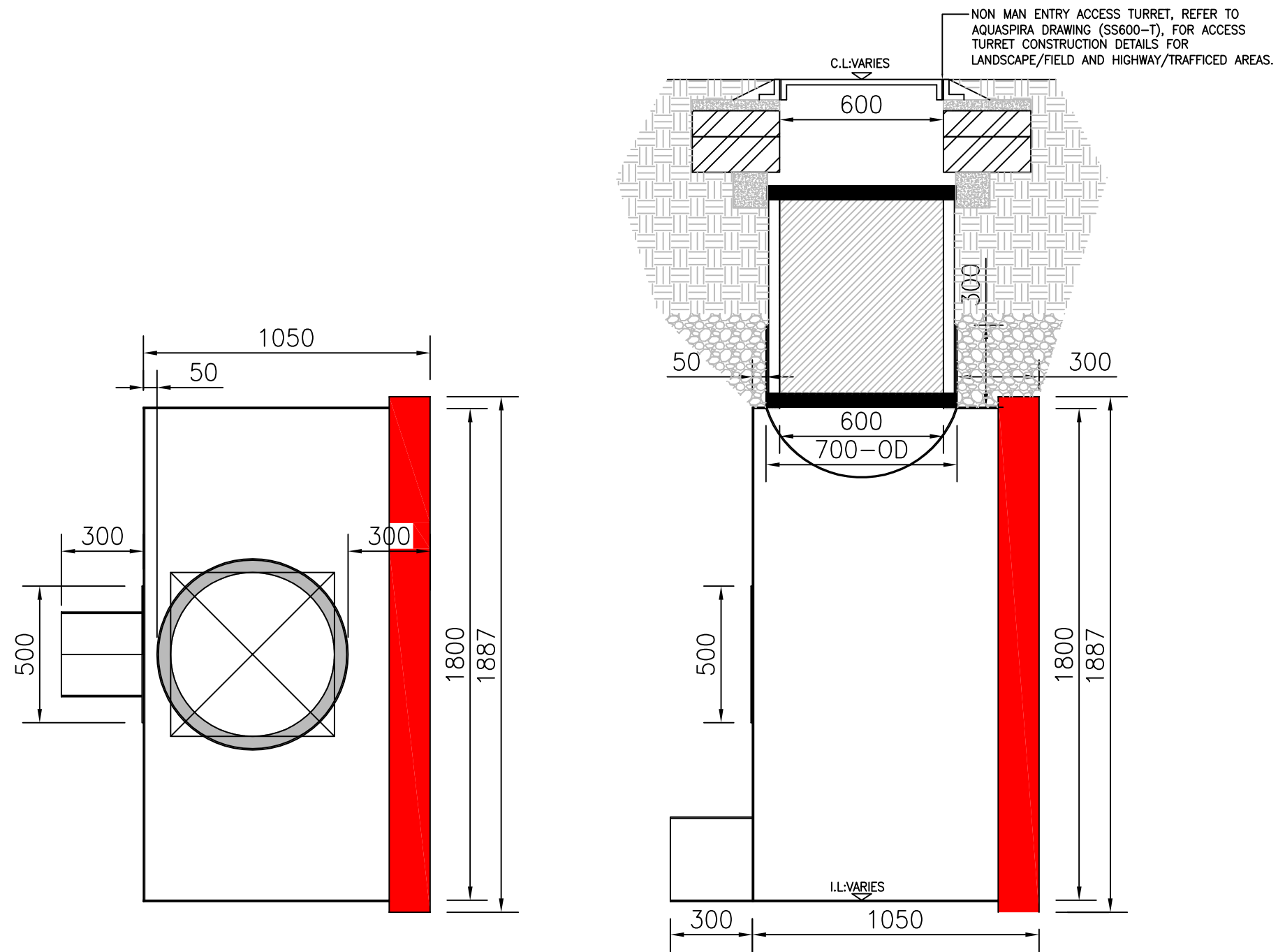

1800 ϕ STAINLESS STEEL
ACCESS END PIPE-NME
(SCALE 1/20)

NOTES:

1. ALL DIMENSIONS ARE NOMINAL AND IN MILLIMETERS.
2. ALL STAINLESS STEEL SPECIFIED TO BE GRADE 316,5MM THICK.

NOTES:

THIS DRAWING HAS BEEN PRODUCED FOR THE PURPOSE OF OFFERING DESIGN AND LAYOUT INFORMATION TO ASSIST THE PROJECT ENGINEER WHEN ASSESSING THE SUITABILITY OF AQUASPIRA PRODUCTS. THE INFORMATION CONTAINED IN THIS DRAWING IS APPROPRIATE TO AQUASPIRA PRODUCTS ONLY, AND ALL REFERENCES TO ASSOCIATED CONSTRUCTION DETAILS ARE OFFERED AS TYPICAL DETAILS AND DO NOT TAKE ACCOUNT OF PROJECT CONDITIONS. THE PROJECT ENGINEER/S MUST SATISFY THEMSELVES THAT THE INFORMATION PROVIDED IN THIS DRAWING IS SATISFACTORY.

CONSTRUCTION
ISSUE

Client
AQUASPIRA
STANDARD DETAIL
DETAIL

Drawing Title.
1800 ϕ STAINLESS STEEL
ACCESS PIPE-NME
300 ϕ INVERT LEVEL



Date 30.03.16	Scale 1/20	Drawn JH	Checked -
Drawing No		1800-SS-I	-

REV	DESCRIPTION	DATE	BY

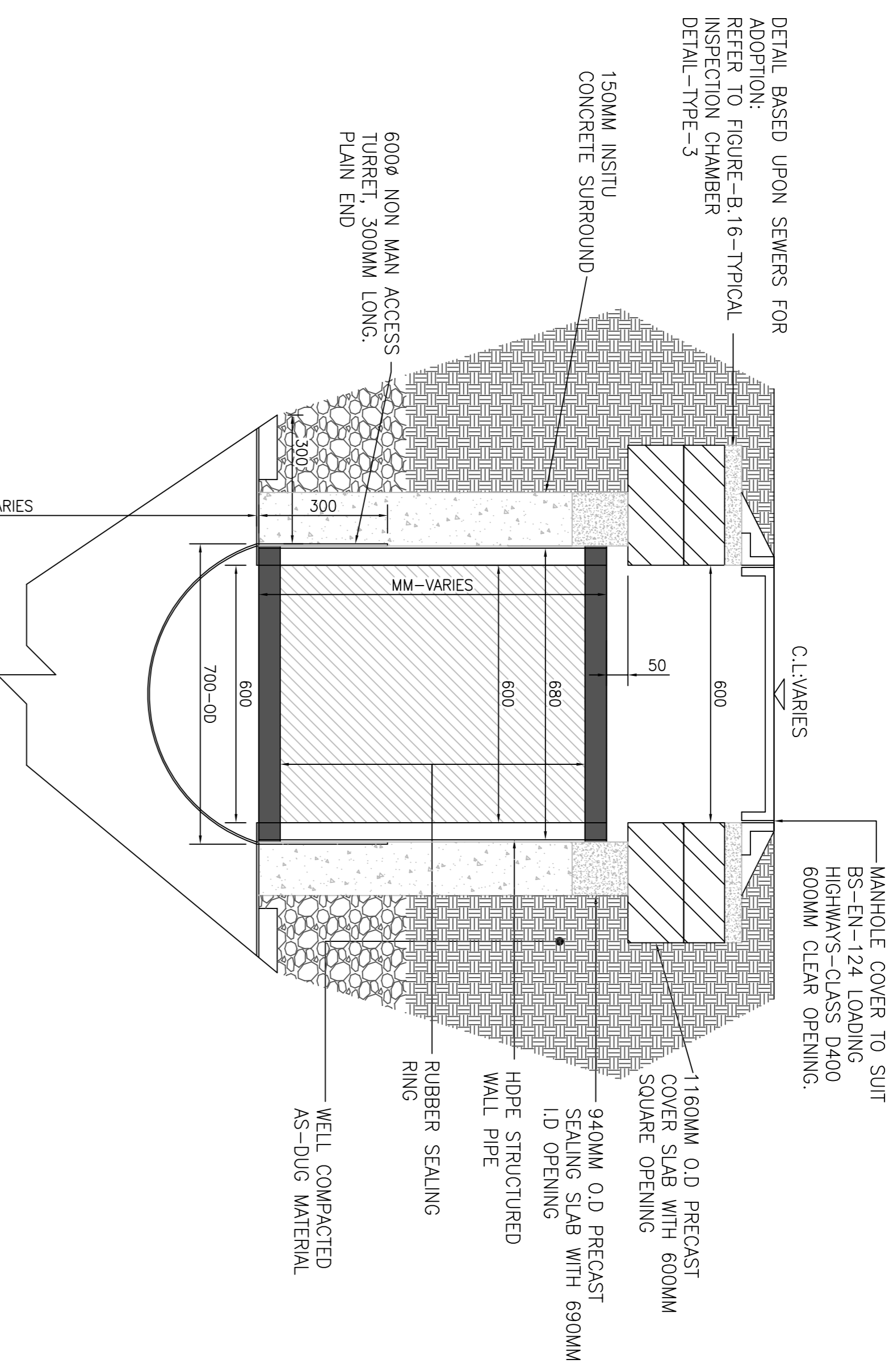

6000 ϕ NON MAN ACCESS CHAMBER FOR
HIGHWAYS/TRAFFICKED AREAS
(6000 ϕ)
(SCALE 1/10)

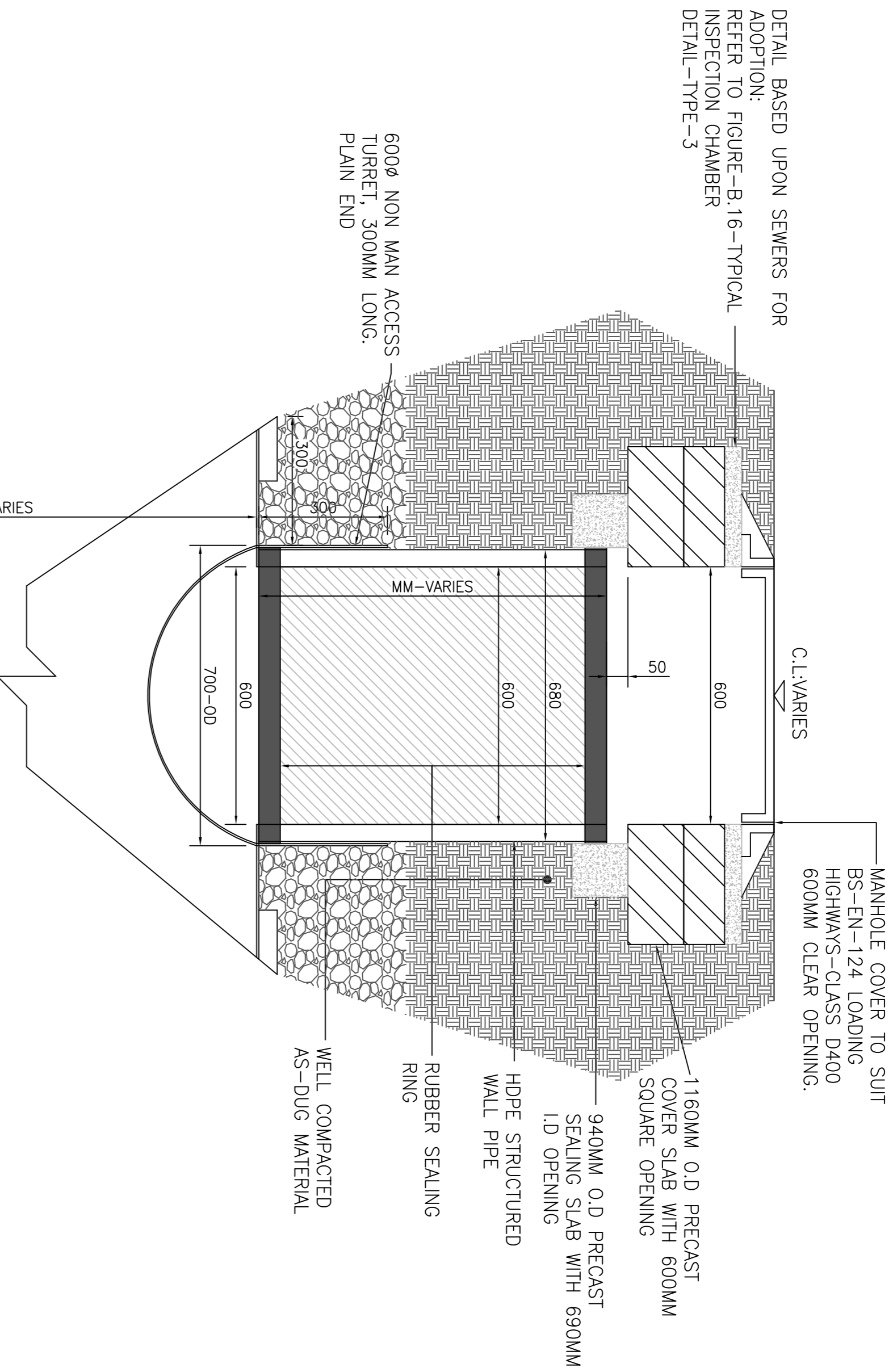

6000 ϕ NON MAN ACCESS CHAMBER FOR
LANDSCAPE/FIELD AREAS
(6000 ϕ)
(SCALE 1/10)

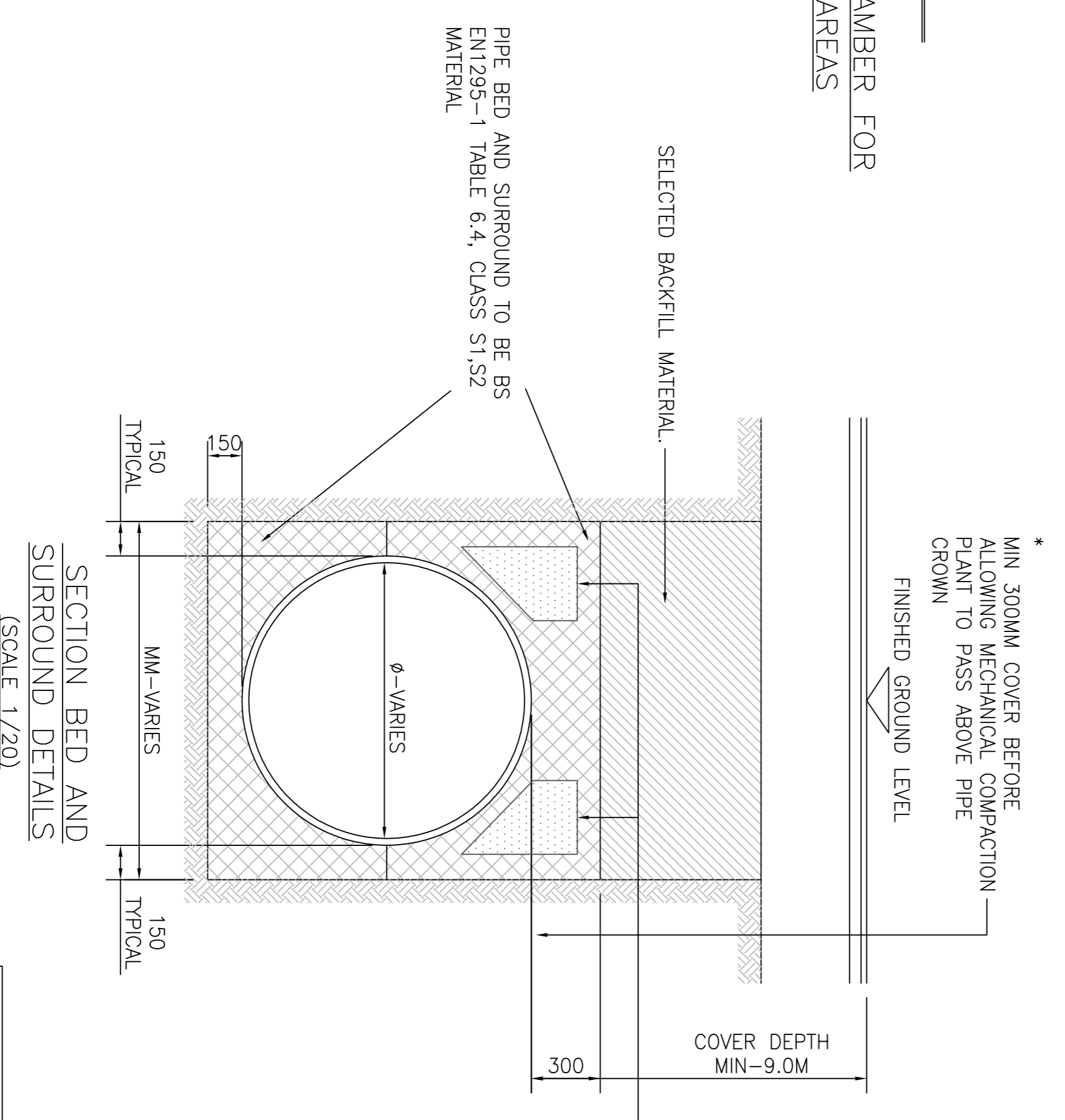

SECTION BED AND
SURROUND DETAILS
(SCALE 1/20)

PIPE BED AND SURROUND TO BE BS EN1293-1 TABLE 6.4, CLASS ST,S2 MATERIAL

SELECTED BACKFILL MATERIAL

* MIN 300MM COVER BEFORE ALLOWING MECHANICAL COMPACTION PLANT TO PASS ABOVE PIPE CROWN

FIRMLY COMPACT THE AREA ABOVE THE SIDEFILL ON EACH SIDE BEFORE COMPACTIONG OVER THE TOP OF THE PIPE

NOTES:

THIS DRAWING HAS BEEN PRODUCED FOR THE PURPOSE OF OFFERING DESIGN AND LAYOUT INFORMATION TO ASSIST THE PROJECT ENGINEER WHEN ASSESSING THE SUITABILITY OF AQUASPIRA PRODUCTS. THE INFORMATION CONTAINED IN THIS DRAWING IS APPROPRIATE TO AQUASPIRA PRODUCTS ONLY, AND ALL REFERENCES TO ASSOCIATED CONSTRUCTION DETAILS ARE OFFERED AS TYPICAL DETAILS AND DO NOT TAKE ACCOUNT OF PROJECT CONDITIONS. THE PROJECT ENGINEER/S MUST SATISFY THEMSELVES THAT THE INFORMATION PROVIDED IN THIS DRAWING IS SATISFACTORY.

NOTES:

- PROPOSED LEVELS ARE APPROXIMATE AND ARE TO BE CONFIRMED BY THE ENGINEER/ARCHITECT PRIOR TO CONSTRUCTION.
 - ALL DIMENSIONS ARE NOMINAL AND IN MILLIMETERS.
 - REFER TO ENGINEERS DRAINAGE DRAWING FOR FULL LAYOUT AND DETAILS.
 - ALL PIPE SPECIFIED TO BE AQUASPIRA CSR.
 - ALL STAINLESS STEEL SPECIFIED TO BE GRADE 316, 5MM THICK.
 - THIS DRAWING TO BE READ IN CONJUNCTION WITH ENGINEERS DRAWINGS AND SPECIFICATIONS.
 - ALL CONNECTING PIPE WORK TO TANKS TO BE DESIGNED BY MAIN ENGINEERS AND SUPPLIED BY CONTRACTOR.
- BACKFILL NOTES
- GRANULAR MATERIAL TO BE THOROUGHLY TAMPED TO ENSURE EVEN SUPPORT AROUND PIPE.
 - ALL TEMPORARY ENABLING WORKS ARE BY OTHERS.
 - PROJECT ENGINEERS TO CONFIRM THE BACKFILL DETAILS ARE APPROPRIATE FOR THE SITE GROUND CONDITIONS AND LOADING CRITERIA.
- PIPE JOINTING
- ALL PRES TO BE JOINED USING AQUASPIRA PUSH FIT JOINTS.
 - ALL STANDARD PRES TO BE JOINED USING ALUMINIUM JOINTING CROSS AS PROVIDED BY AQUASPIRA.
 - ALL FABRICATED OR MODIFIED SECTIONS TO BE JOINED USING THE SLING AND RATCHET SYSTEM TO AVOID DAMAGE TO THE SECTION.

Client	AQUASPIRA STANDARD DETAIL
Drawing Title	6000 ϕ STAINLESS STEEL NON MAN ACCESS TURRET AND CONSTRUCTION DETAILS
Date	N/A
Scale	AS SHOWN
Drawn	JH
Checked	MS
Drawing No	600-S/S

